

# **KIENE CC2055 Starter Motor Adapter**

## **INSTRUCTIONS FOR USE**

**CAUTION:** Before attempting to use this device, read and understand these instructions.

### **Assemble CC2055 Starter Motor Adapter as follows:**

1. Assemble CC2055-1 Starter Adapter loosely to CC2055-6 Swivel Bracket using hex head cap screw and flat washer provided.
2. Mount this assembly onto either CC2055-2 Starter Adapter Bracket or CC2055-7 Starter Adapter Post & Pin. You will have to determine which arrangement provides the best access to the starter motor, without interference from engine or suspension components or chassis frame members.

### **Install CC2055 Starter Motor Adapter onto CC2000 Clutch Caddy as follows:**

1. Loosen 3/8-16 set screw in Pivot Block.
2. Remove Clutch Holder Assembly and install CC2055 Starter Motor Adapter into Pivot Block.
3. Tighten 3/8-16 set screw so that Adapter is free to pivot, but will not pull out of Pivot Block.

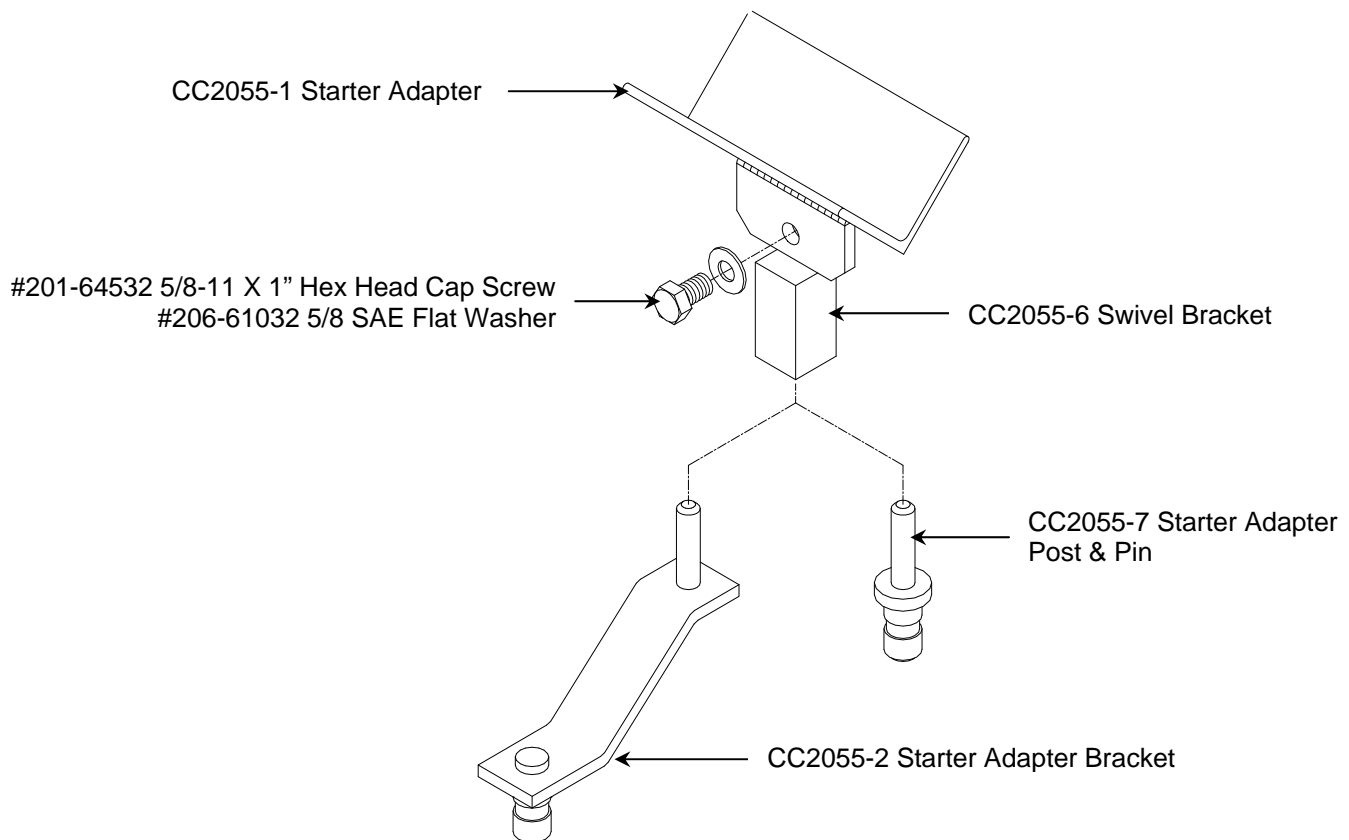

**KIENE**  
DIESEL ACCESSORIES, INC.

616-531-8868  
www.UNIQUETRUCK.COM

**UNIQUE**  
TRUCK EQUIPMENT